

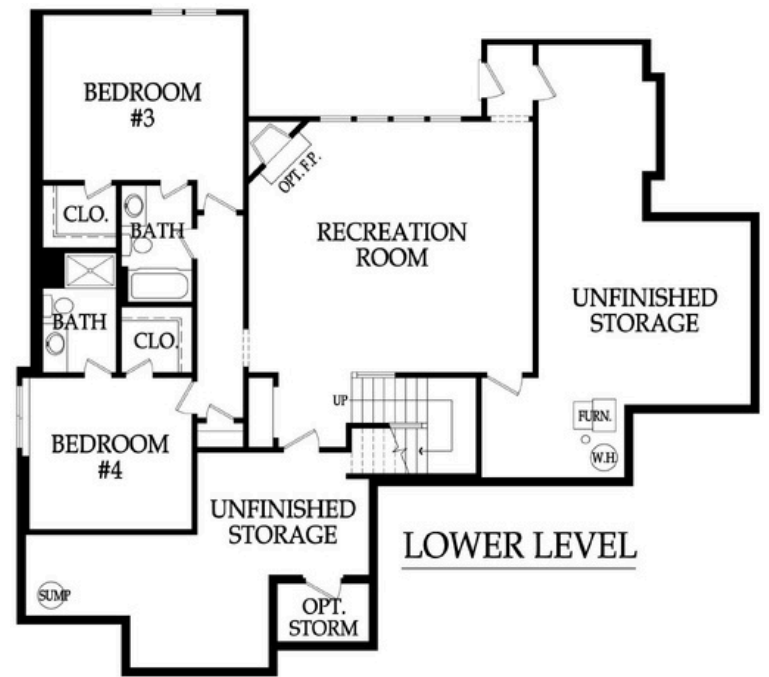

French Country



Craftsman with Front Porch



Renderings are for illustration purposes only and may show upgrades. The materials used on the renderings are only examples of what can be installed. Consult Builder for details.

Appliances

Stainless Steel Appliance Package: Dishwasher, Gas Cooktop, Hood Insert - Vented to Exterior, Wall Oven, & Microwave (GE Profile)
Ice Maker Water Line at Refrigerator Opening

Plumbing and Fixtures

50 Gallon Water Heater
Lower-Level Bar Stub
Chrome Plumbing Package Throughout the Home
Drop-In Jetted Tub & Frameless Shower Door in Primary Bath

Cabinets and Countertops

Choice of Knotty Alder, Birch, Poplar, or Paint Grade Cabinets
Kitchen Cabinets include Hidden Hinges, Adjustable Shelving, Full Extension Drawer Glides, Pull-Out Trash Can, & Spice Rack
Walk-In Pantry with 5 Shelves
Level 1 Granite/Quartz Tops in Kitchen with Undermount Stainless Steel Sink
Level 1, 2cm Quartz in all Bathrooms
Base + Upper Cabinet per Plan at Laundry with Level 1, 2cm Quartz

Electrical and Low Voltage

200 AMP Service Panel with Breakers
LED Light Bulbs in all Can Lights
3 Exterior Outlets (minimum)
Keypad on Garage Doors
Wired & Switched for Ceiling Fan in Hearth Rooms & All Bedrooms
Prewire for Security System
Cat6 Wiring with Cable/Data Locations in all Bedrooms, Hearth Room, & Study per Plan
Under Cabinet Wiring in Kitchen per Plan

Energy Efficient Features

96% Lennox Furnace with Humidifier and 14 SEER A/C
Engineered for Maximum Energy Efficiency
ZIP System Wall Sheathing
Independently Rated RESNET HERS Index Home
Blown-In Blanket Insulation
Energy Star Compliant Foam and Caulk Package
Air Sealant in the Attic
Energy Efficient Low-E Windows (choice of white or sandstone)

Exterior

9' Foundation Walls with Concrete Egress Window Well
Limited Lifetime Warranty Roof
Front: Stucco and Stone per Elevation with LP Smart Trim
Sides/Rear: LP Smart Siding and Trim, 5/50 Limited Warranty
5" Aluminum Gutters (Choice of Color)
Insulated Garage Door with Openers and Smart Capabilities
6'-8" Fiberglass Front Door w/Clear Glass Side Lites per Plan
Covered Patio, Optional Covered Deck w/Composite Flooring
2 Exterior Hose Bibs, Mounted AC Unit to Foundation

Fireplace, Trim, and Mirrors

Direct Vent Fireplace with Tile Surround
Built-in Boot Bench per Plan
Stained Stair End Caps with Iron Spindles
Oil Rubbed Bronze or Brushed Nickel Doorknobs & Hinges
Trim Wrapped Mirrors in all Baths
Large Base and Casing throughout Main Floor
Choice of 6 Interior Door Styles
Crown Molding per Plan, Box Vault in Primary Bedroom
Expansive Ceiling in Great Room, Box Vault in Breakfast Area

Flooring and Tile

Standard Hardwood Floors: Pre-Finished Floors located in Entry, Kitchen, Great Room, Mud Room, Main Floor Guest Bath, and Breakfast Area per Plan
Ceramic Tile Floors in Laundry, Primary Bath, and Secondary Baths
Ceramic Tile on all Shower Walls, Tub Walls, & Kitchen Backsplash
Ceramic Tile in Primary Shower Pan

Paint

Interior: 3 Wall Colors (Flat/Latex), 1 Enamel, 1 Stain (in addition to stain on hardwoods)
White or Light colors and Ultra Dark colors may incur an additional charge.
Exterior: 1 Body Color, 1 Trim Color, 1 Accent Color
White or Light colors may incur an additional charge.

Site Work

Site Cost Coverage-up to \$10,000 (See Addendum)
Landscaping Allowance of \$3,000 unless specified otherwise in CUP
Fully Sodded Lot with Bluegrass Sod up to 11,000 SF
Sump Pump

Standard Allowance

Appliances: \$3,475
Lighting: \$4,000
Tile: Standard (See Addendum)
Carpet: \$1.78 per Square Foot
Stair Carpet: \$3.90 per Square Foot
Commission: Home Site up to \$120,000

Experience the Bickimer Difference

HVAC Ductwork Professionally Cleaned at Closing
Plumbing Drain Lines Professionally Inspected at Closing
On-site Meetings throughout the Build
In-House Warranty Program with Unmatched Customer Service
Professional Expert with you during the Sales Process, Build Process, and Warranty Process
Full Access to Professional Decorator and Design Center
Passive Radon